

# **INITIAL RECEIPT**

**United States Department of the Interior  
Bureau of Land Management  
DIV OF LANDS, MINRLS & ENERGY  
ONE N CENTRAL AVE  
PHOENIX, AZ 85004 -4427  
Phone: 602-417-9200**

Receipt

No: 4842866

<b>Transaction #:</b> 4971062	
<b>Date of Transaction:</b> 11/27/2020	
CUSTOMER:	
SCHWARZBACH <i>STEVEN</i> 36675 S SCENIC LOOP RD WICKENBURG, AZ 85390-3655 US	

LINE #	QTY	DESCRIPTION	REMARKS	UNIT PRICE	TOTAL
1	1.00	LOCATABLE MINERALS / MINING CLAIMS-NEW, UNADJUD, ONE OR MORE AUTH NOS / NEW MINING CLAIM PROCESSING FEE CASES: AMC461875/\$20.00		- n/a -	20.00
2	1.00	LOCATABLE MINERALS / MINING CLAIMS-NEW, UNADJUD, ONE OR MORE AUTH NOS / NEW MINING CLAIMS LOCATION FEE CASES: AMC461875/\$40.00		- n/a -	40.00
3	1.00	LOCATABLE MINERALS / MINING CLAIMS-NEW, UNADJUD, ONE OR MORE AUTH NOS / NEW MINING CLAIMS MAINTENANCE FEE CASES: AMC461875/\$165.00		- n/a -	165.00
<b>TOTAL:</b>					<b>\$225.00</b>

PAYMENT INFORMATION			
1	AMOUNT:	225.00	POSTMARKED: N/A
	TYPE:	CHECK	RECEIVED: 11/27/2020
	CHECK NO:	1363	
	NAME:	ADVENTURES OF A LIFETIME ATV 36675 S SCENIC LOOP RD WICKENBURG AZ 85390-3655 US	

REMARKS

**ENTERED**  
**DEC 03 2020**  
BY: *[Signature]*

This receipt was generated by the automated BLM Collections and Billing System and is a paper representation of a portion of the official electronic record contained therein.

# **CORRESPONDENCE**

# **TRANSFERS**

**MAINTENANCE FEES**  
**WAIVERS**  
**POL/NOI**

# **MISCELLANEOUS**

**LOCATION NOTICES  
AMENDMENTS  
STATUS SHEET  
GEO REPORT/MTP**

# MINING CLAIM STATUS REPORT - Assessment Year 2020-2021

Data Entered: 12/03/2020 ncu

MTP Checked By: TCU

GEO Checked By: TCU

LEAD SERIAL NUMBER: AMC 461875 thru AMC -

### NUMBER OF CLAIMS & TYPE:

1 LODE  
1 PLACER  
ASSOCIATION PLACER  
MILL SITE  
TUNNEL SITE

### CHARGES:

Processing Fee @ \$20 = \$ 20  
Location Fee @ \$40 = \$ 40  
Maintenance Fee @ \$165 = \$ 165  
Add'l Maint Fee for Assoc Placer = \$  
SUBTOTAL \$ 225  
Other Fees \$  
Other Fees \$  
TOTAL \$

TOTAL ACREAGE: 20 Per Claim  
(Placer Only)

NUMBER OF LOCATORS: 2

DOCUMENTS RECEIVED VIA: Over-the-Counter [ ] Mail [ X ] TIMELY FILED: Yes [ X ] No [ ]

LEGAL DESCRIPTION: T 7N R 3W SEC 27  
T R SEC  
T R SEC  
T R SEC  
T R SEC

BLM [ ] FOREST SERVICE [ ] SUBJ TO PL 359: Yes [ ] No [ ]  
WILDERNESS AREA [ ]

SPLIT ESTATE: N/A [ ] SX [ ] PX [ ] OTHER [ ]  
SRHA [ ] Was proper Notice filed if located on SHRA Land? Yes [ ] No [ ]

### RECONVEYED MINERALS ON BLM LAND REQUIRE OPENING ORDER FROM 1944 TO 1993:

Open to Entry On \_\_\_\_\_ N/A [ ]

COMMENTS/STATUS: VOID [ ] PARTIALLY VOID [ ] PVT MINERALS [ ] WITHDRAWN LANDS [ ]  
OTHER [ ]

[ ] Claimant acknowledges that portions of the following claim(s) site(s) may be void or voidable.

Printed Name of Claimant \_\_\_\_\_ Signature of Claimant \_\_\_\_\_

\*\*\*\*\*FINAL ADJUDICATION\*\*\*\*\*

DATE \_\_\_\_\_ INITIALS \_\_\_\_\_



**LOCATION NOTICE FOR PLACER MINING CLAIM**

Amendment BLM Serial # \_\_\_\_\_

NOTICE IS HEREBY GIVEN that the "Alibu 27-2"

placer mining claim has been located

by Laura Darbyson & Steve Schwarzbach whose current mailing

address is 36675 South Scenic Loop Road, Wickenburg, AZ 85390

BLM  
Date  
Stamp

PHOENIX, ARIZONA

2020 NOV 27 P 2: 36

RECEIVED  
BLM-AZ STATE OFFICE

The general course of this claim is North and South and it is situated in Maricopa

County, Arizona. This claim is 1,320 feet in length and 660 feet in width.

20 Total Claim Acreage. This claim runs from the location monument on which this location notice

is posted 33' 55' 12 N & 112' 39' 11' W from coordinates proceed N 660 ft then W 660 ft then S 1320 ft then E 660 ft then N 660 to start coordinates. This claim is marked by six

monuments, one at each corner and one at the center of each end line of the claim.

The location monument on which this notice is posted is situated within Section 27, Township 7.

North, Range 3 West Gila Salt River Base and Meridian, Arizona and this claim encompasses portions

of the following quarter section(s), section(s), Township(s) and Range(s) NW 1/4 of the NE 1/4 of SE 1/4 of Section 27 and SW 1/4 of the SE 1/4 of the NE 1/4 of Section 27.

Gila Salt River Base and Meridian, Arizona.

The locality of this claim with reference to some natural object or permanent monument and additional information

(if any) concerning its locality are as follows: This claim is located approximately 2 miles SW of San Domingo Peak and encompassing the wash running NE to SW through claim.

The above information is shown on the attached map.

DATED AND POSTED on the ground this 20 day of November, 2020.

LOCATOR(s)  AGENT

Print Name(s) Steve Schwarzbach Laura Darbyson

Signature(s) [Handwritten Signature] Jane Darbyson

Form MCF100  
Revised Oct 2018

This form is available from the Arizona Geological Survey and may be reproduced.

AMC461875

**MINING CLAIM MAP**

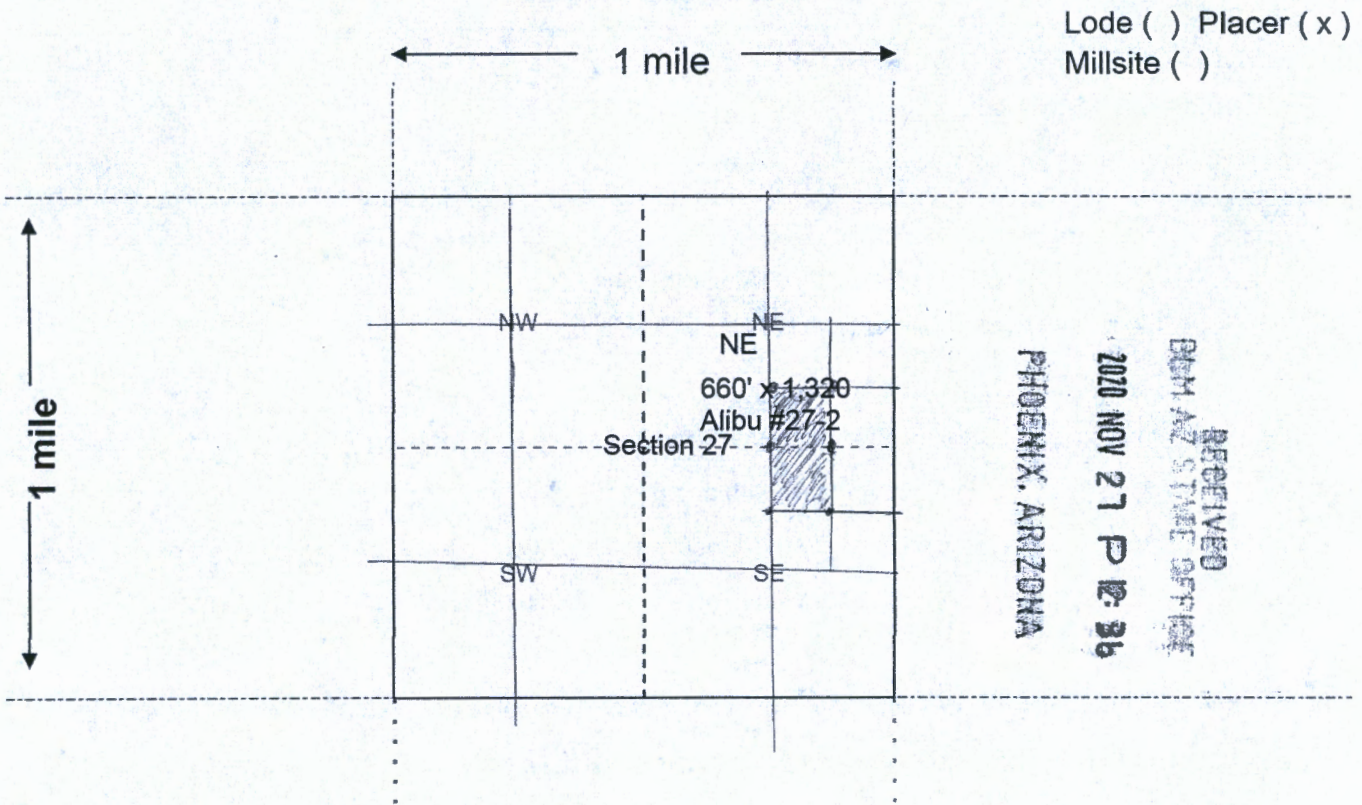

Lode ( ) Placer (x)  
Millsite ( )

RECEIVED  
BHM AZ STATE OFFICE  
2020 NOV 27 P 12:36  
PHOENIX, ARIZONA

Scale: 1" = 2000 feet



1. The above map depicts the Alibu #27-2 mining claim, which is located in Section (s) 27, Township 7 N, Range 3 W, Gila and Salt River Base and Meridian, Maricopa County, Arizona. Total claim acreage is 20.
2. The type of corner and location monuments used are as follows: 2" Poly Pipe, 4 feet long/cap
3. The bearings and distances in degrees and feet between claim corners and to a public land survey monument are as depicted on the map.
4. If the claim is a placer or millsite claim with exterior limits conforming to legal subdivisions of the public survey, provide a legal description of the claim Meridian Number 14, Gila-Salt River Meridian, Section 27, Township 7N 3W, 20 acres NE NE

AMC461875

Form MCF100a  
Revised Oct 2018

Date and Time Run:  
12/4/2020 8:56:00 AM

Page 1 of 1

DEPARTMENT OF THE INTERIOR  
BUREAU OF LAND MANAGEMENT  
Case Recordation

**Geographic Report with Land**

Disposition is equal to **AUTHORIZED , CANCELLED , EXPIRED , PENDING , REJECTED , RELINQUISHED ,  
WITHDRAWN**  
and Meridian Township Range Section is equal to **14 0070N 0030W 027**  
and Admin State is equal to **AZ**

NO WARRANTY IS MADE BY BLM  
FOR USE OF THE DATA FOR  
PURPOSES NOT INTENDED BY BLM

DEPARTMENT OF THE INTERIOR  
BUREAU OF LAND MANAGEMENT  
Case Recordation  
Geographic Report with Land

Admin State: AZ  
Geo State: AZ  
Serial Number: AZA 031961

Total Case Acres: 1.000

CaseType	Case Disp	Mer	Twp	Rng	Sec	Sur Type	Sur Nr	Suf	Subdivision	Pending Action
293200	EXPIRED	14	0070N	0030W	027	FF			PORTION OF;	

Admin State: AZ  
Geo State: AZ  
Serial Number: AZA 033674

Total Case Acres: 1.000

CaseType	Case Disp	Mer	Twp	Rng	Sec	Sur Type	Sur Nr	Suf	Subdivision	Pending Action
293200	EXPIRED	14	0070N	0030W	027	FF			PORTION OF;	





Steven Schwarzbach  
36675 S. Scenic Loop Rd.  
Wickenburg, AZ 85390

PHOENIX AZ 852

23 NOV 2020 PM 6 1



RECEIVED  
DLM AZ STAG OFFICE  
2020 NOV 27 P 2: 36  
PHOENIX, ARIZONA

DLM  
Div of Lands, Minerals & Energy  
One N. Central Ave  
Phoenix, AZ 85004-4427

85004-441499

